

WEITERGABE SOWIE VERVIÄLFÄHIGUNG DIESES DOKUMENTS, VERWERTUNG UND MITTEILUNG SEINES INHALTS SIND VERBOTEN, SOWEIT NICHT AUSDRÜCKLICH GESTÄTTET. ZUWIDENMÄNDLUNGEN VERPFLICHTEN ZU SCHADENSATZ. ALLE RECHTE FÜR DEN FALL DER PATENT-, GEBRAUCHSMUSTER- ODER GESCHMACKSMUSTEREINTRAGUNG VORBEHALTEN.  
 FIRST ANGLE PROJECTION Projektionsmethode 1  
 THE REPRODUCTION, DISTRIBUTION AND UTILIZATION OF THIS DOCUMENT AS WELL AS THE COMMUNICATION OF ITS CONTENTS TO OTHERS WITHOUT EXPRESS AUTHORIZATION IS PROHIBITED. OFFENDERS WILL BE HELD LIABLE FOR THE PAYMENT OF DAMAGES. ALL RIGHTS RESERVED IN THE EVENT OF THE GRANT OF A PATENT, UTILITY MODEL OR DESIGN.

BRAKE CHARACTERISTICS (BEM-1.2H-24-8)				
OPERATING VOLTAGE	U	=	24 ± 2,4	V DC
RATED TORQUE (DYNAMIC FRICTION TORQUE) BASED ON Dn=100 rpm	M <sub>k</sub>	=	120	Ncm
OPERATING TEMPERATURE	T	=	-10 TO +40	°C
MAX. ROTATION SPEED	n <sub>max.</sub>	=	10000	min <sup>-1</sup>
ARMATURE MOMENT OF INERTIA	J	=	1,0 x 10 <sup>-6</sup>	kg x m <sup>2</sup>
ARMATURE PULL-IN TIME	t <sub>a</sub>	=	0,004	s
TORQUE BUILD-UP TIME	t <sub>p</sub>	=	0,010	s
TORQUE DECAVING TIME	t <sub>d</sub>	=	0,010	s

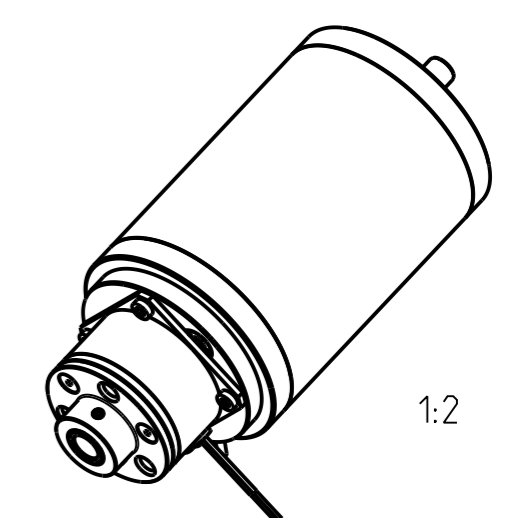
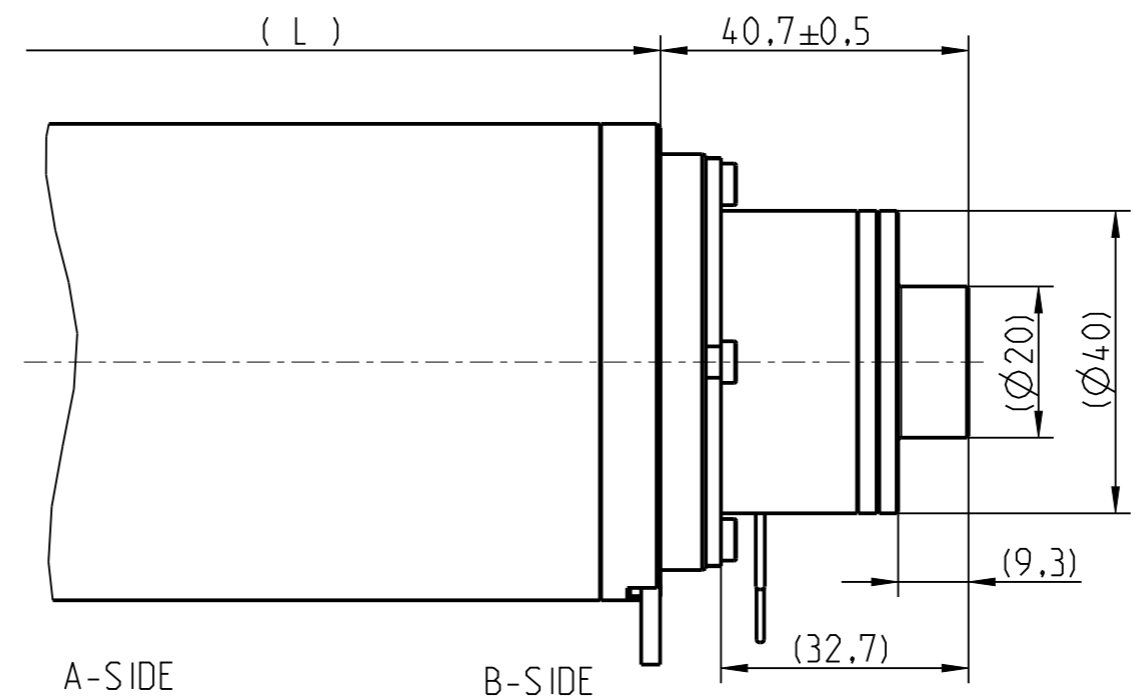
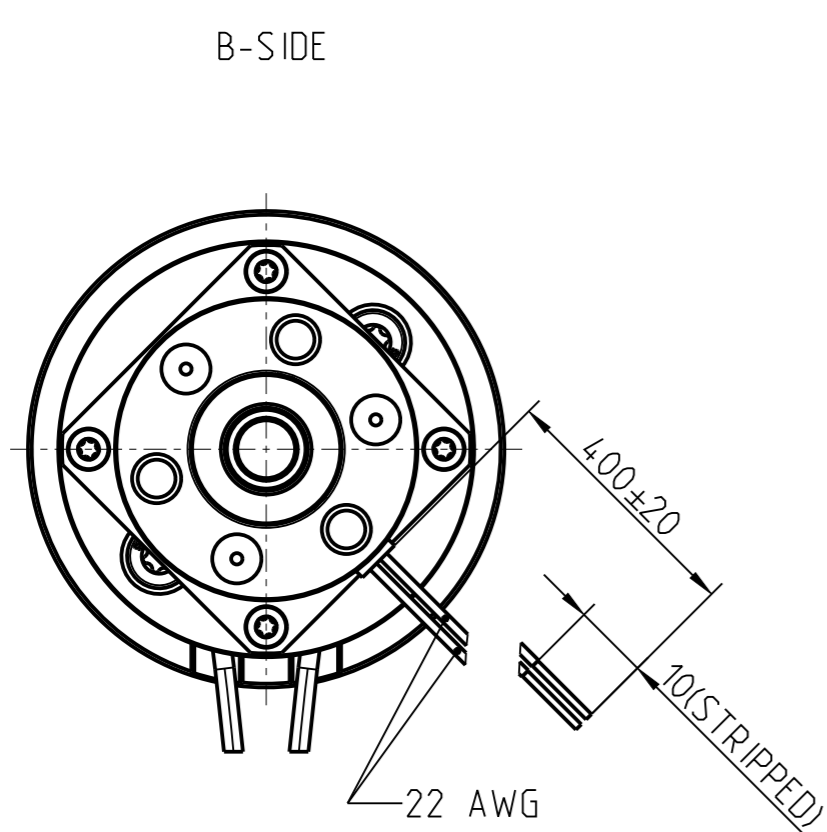

GENERAL TOLERANCES		MATERIAL		WT-PART NUMBER	
-		POWER-ON BRAKE BEM-1.2H		13000596	
TOLERANCING		CHANGE DESCRIPTION		CREATED	
ISO 8015				M.Semmlinger	
THEORETICAL MASS		0x ② EDITORIAL CHANGES		APPROVED	
(231.32 g)				Bretschneider	
SCALE	SIZE	TITLE		DOCUMENT STATE	
1:1	DIN A3			Design Released	
		bMotion PMDC 63x95		DOCUMENT REVISION	
				13001984 2	
DIMENSIONS IN mm		ENGLISH WORDING IS BINDING		DATE OF ISSUE SHEET	
				2024-05-21 10/10	
				ASSEM DRAWING	