

BSF-1,0H-24-8

B-SIDE

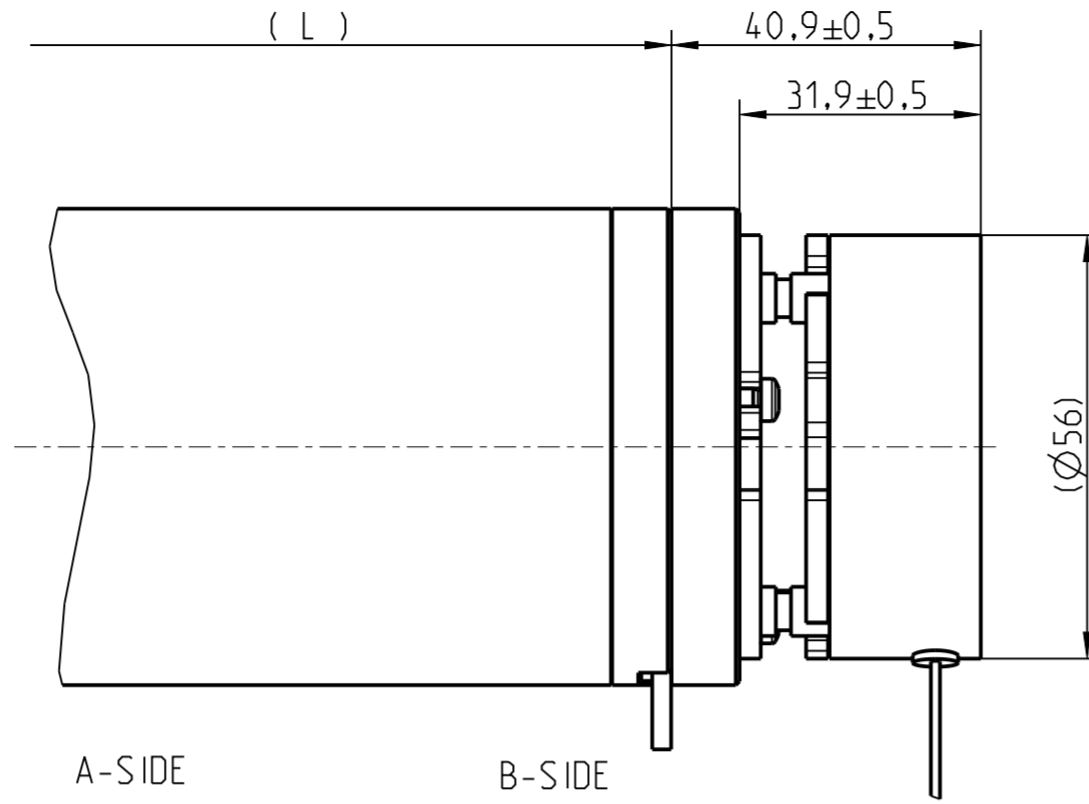

BRAKE CHARACTERISTICS (BSF-1,0H-24-8; BSF-1,0H-24-8-L)			
OPERATING VOLTAGE	U	=	24 ± 2,4 V DC
RATED TORQUE (STATIC FRICTION TORQUE)	M <sub>k</sub>	=	100 Ncm
OPERATING TEMPERATURE	T	=	-10 TO +40 °C
MAX. ROTATION SPEED	n <sub>max.</sub>	=	5000 min <sup>-1</sup>
ROTATING PART MOMENT OF INERTIA	J	=	3,8 x 10 <sup>-6</sup> kg x m <sup>2</sup>
ARMATURE PULL-IN TIME	t <sub>a</sub>	=	0,035 s
ARMATURE RELEASE TIME	t <sub>ar</sub>	=	0,020 s

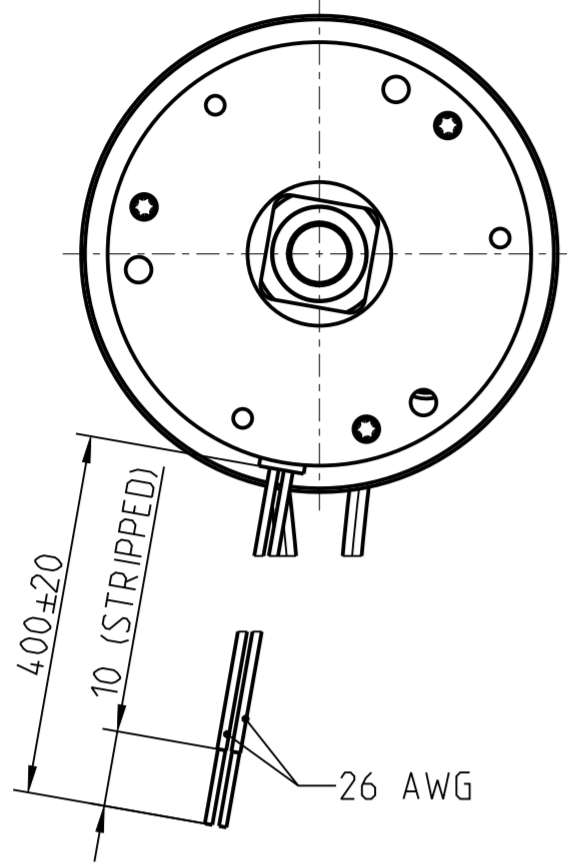
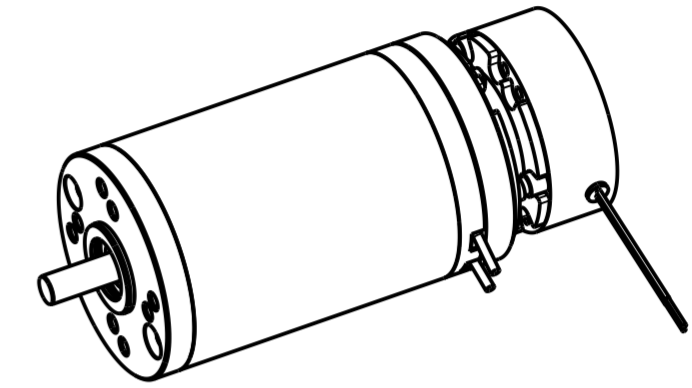

1:2

BSF-1,0H-24-8-L

B-SIDE

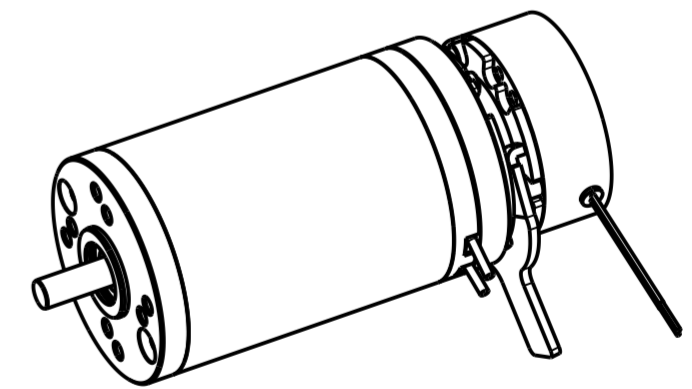
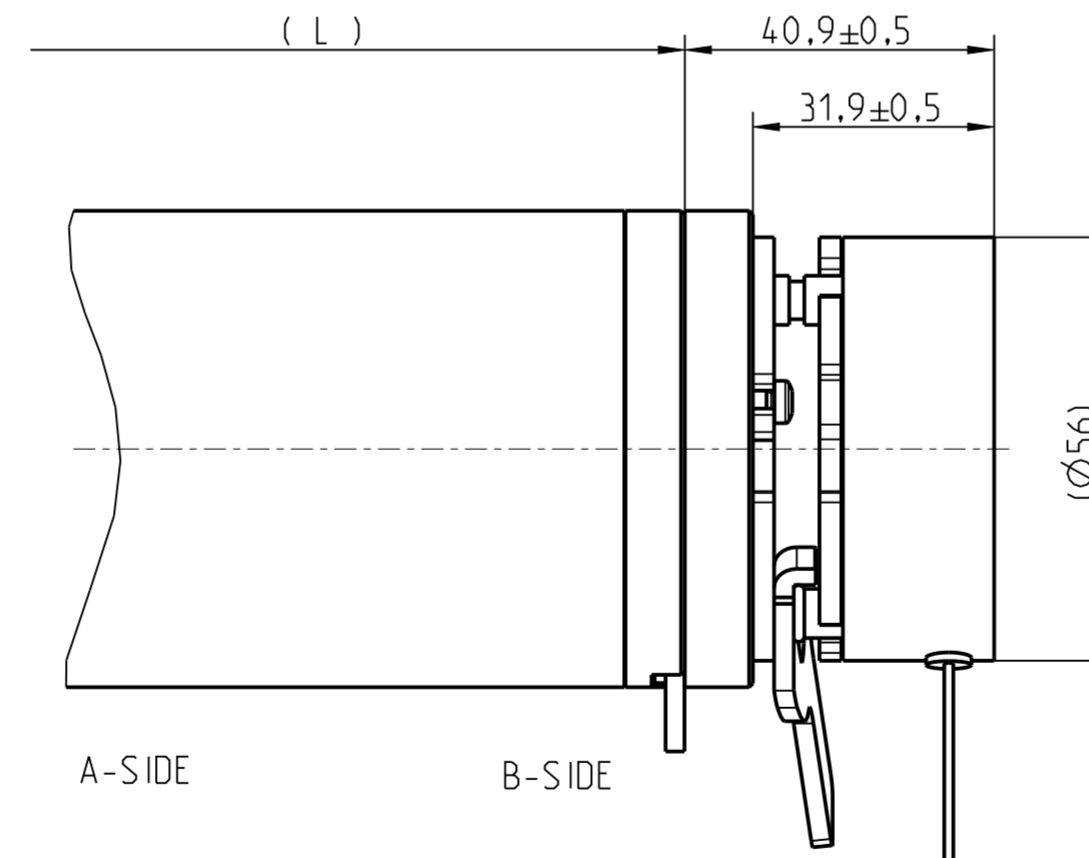
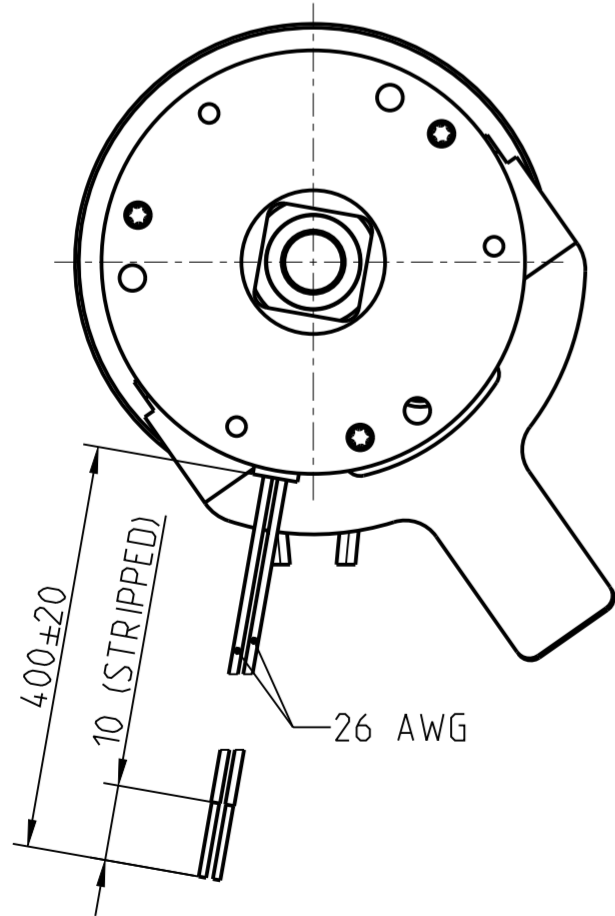

1:2

GENERAL TOLERANCES		MATERIAL		WT-PART NUMBER	
-		POWER-OFF BRAKE BSF-1,0H		13000596	
TOLERANCING				CREATED	
ISO 8015				M.Semmlinger	
THEORETICAL MASS		CHANGE DESCRIPTION		CHANGE NUMBER	
(231,32 g)		0x ② EDITORIAL CHANGES		APPROVED	
SCALE		SIZE		PREVIOUS VERSION	
1:1		DIN A2		-	
Bühler Motor		Bühler		DOCUMENT STATE	
		TITLE		DESIGN RELEASED	
		bMotion		DOCUMENT REVISION	
		PMDC 63x95		13001984 2	
		DIMENSIONS IN mm		DATE OF ISSUE SHEET	
		ENGLISH WORDING IS BINDING		2024-05-21 9/10	
				ASSEM. DRAWING	

Wiedergabe sowie Vervielfältigung dieses Dokuments, Verwertung und Verbreitung, ohne schriftliche Genehmigung der Bührler AG, ist ausdrücklich untersagt und kann strafrechtlich verfolgt werden. Alle Rechte für den Fall der Patent-, Gebrauchsmuster- oder Geschmacksmusterrechte vorbehalten.

THE REPRODUCTION, DISTRIBUTION AND UTILIZATION OF THIS DOCUMENT AS WELL AS THE CONSTRUCTION OF IDENTICAL OR SIMILAR DEVICES WITHOUT EXPRESS WRITTEN PERMISSION IS PROHIBITED. OFFENDERS WILL BE HELD LIABLE FOR THE PAYMENT OF DAMAGES. ALL RIGHTS RESERVED IN THE EVENT OF A PATENT, UTILITY MODEL OR DESIGN.

FIRST ANGLE PROJECTION  
 Projektionsmethode 1